

BSUR | 20 BAUS Endo | 23

Harrogate Convention Centre
14-15 September 2023

Programme

**Joint Annual Meeting:
British Society of Urogenital Radiology
British Association of Urological Surgeons, Endourology Section**



HARROGATE

Welcome

Dear Delegate,

We are delighted to warmly welcome you to the beautiful spa town of Harrogate, gateway to Nidderdale area of outstanding natural beauty and home to life's Yorkshire essentials such as Betty's tea cakes & fat rascals, Yorkshire Tea and Harrogate Spring Water. Endo Urology and Uro-radiologists are a great team in the NHS so it is exciting to have our second joint BSUR and BAUS Endo joint meeting after the inaugural meeting, 2007 in Edinburgh. We hope you find the programme stimulating, we have worked hard to address the needs of all our members, Endo-Urology, Uro-Radiology and Gynae-Radiology and look forward to seeing you in the truly Majestic Hotel for the conference dinner on Thursday. Many thanks for joining us, and don't forget to make time to relax in the Turkish Baths!



Faye Cuthbert, Chairperson, BSUR

Atif Khan, Conference Organiser, BSUR

Harry Bardgett, Conference Organiser, BSUR

Dear Colleagues,

We are really excited about the 2023 BAUS Section of Endourology meeting, held in conjunction with the British Society of Urogenital Urology (BSUR). We trust that you will find the academic programme interesting and relevant to your everyday practice, and we hope that you will enjoy the social aspects of the meeting too!

The first day of the conference is a celebration of the strong friendship between urology and radiology. The plenary sessions focus on topics relevant to both specialities including the future provision of emergency non-vascular interventional radiology. This year, we are honoured to have Dr Clare Allen, Consultant Radiologist from UCLH as our Malcolm Coptcoat Lecturer, and it will be fascinating to hear her reflections on a stellar career in uro-radiology.

On the second day, we will cover a wide range of endourology topics. For the first time, we have a plenary on Friday morning dedicated to the tremendous work that our endourology clinical nurse specialists do. There is also a session showcasing "office endourology" procedures for stone disease, BPH and non-muscle invasive bladder cancer. Of course, there will also be a selection of presentations from our trainees across the country.

We hope you can join us in Harrogate in September for what promises to be a fun and informative 2 days.



Prof Sri Sriprasad

Chair
BAUS Section of
Endourology



Hari Ratan
Hon Secretary
BAUS Section of
Endourology

BPH Solutions	See	Treat
iTind	✓	✓
TURP	✓	✓
HOLEP/ThuFLEP	✓	✓
BNI	✓	✓
Prostatectomy	✓	✓

NMIBC Solutions	See	Treat
Cystoscopy Therapeutic	✓	✓
Cystoscopy Stone	✓	✓
Diagnostic Cystoscopy	✓	
TURBT	✓	✓

Stone Solutions	See	Treat
Ureteroscopy Therapeutic	✓	✓
Ureteroscopy Stone	✓	✓
Diagnostic Ureteroscopy	✓	
PCNL	✓	✓
Ureteroscopy	✓	✓
Lithotripsy	✓	✓
Nephroscopy	✓	



One Stop Solution

For All Urology Procedures

As a complete urology provider we are active in the spheres of BPH, NMIBC, stone management, and laparoscopic urology. Olympus is unremittingly dedicated to the development of new innovative products and the high-quality training of urologists.

Scan here for
more information



Registration Fees - BSUR/BAUS Endo Joint Meeting

	Whole Meeting Early Rate until 12:00 noon Wednesday 9 August	Whole Meeting Standard Rate until 17:00 on Monday 11 September	Thursday 14 September Early Rate until 12:00 noon Wednesday 9 August	Thursday 14 September Standard Rate until 17:00 on Monday 11 September	Friday 15 September Early Rate until 12:00 noon Wednesday 9 August	Friday 15 September Standard Rate until 17:00 on Monday 11 September
BSUR Member & BAUS Member (Specialist Register / Urological Specialist / International Members / Semi-Retired Members)	295	370	200	250	150	190
Non-Member: Radiologist / Urologist / Other	370	465	250	315	190	240
BSUR Member Trainee & BAUS Member Trainee and Allied Health Professional	150	190	100	125	75	95
Non Member: Radiology Trainee / Urology Trainee / Healthcare Professional / Scientist	190	240	125	160	95	120

Onsite rates will be Standard Rates plus £50

CME Points

Thursday 14 September: 6 Points

Friday 15 September: 5 Points

Pi™ Prostate Intelligence

Prostate AI with expert level performance



Improving the Diagnostic Pathway and workflow

Pi™ automatically processes prostate MRI scans, integrating with existing PACS and RIS, for analysis by radiologists at the time of reporting

Outputs include contoured prostate and lesions for fusion biopsy and therapy planning, saving time and reducing workload

Risk scores support improved detection of cancer, biopsy avoidance and workflow prioritisation according to clinician and patient preferences

General Information

Address

Harrogate Convention Centre,
King's Rd
Harrogate
HG1 5LA
Please use Entrance 3

Access

BSUR & BAUS Endourology Lectures will take place in the Queens Suite, BSUR Gynae Lectures will take place in the Crown Suite. The exhibition, catering and poster display will be in Hall D. Registration will take place on the mezzanine.

App

Please download The Event App by Events AIR
Event Code: bsurendo

Badges

All delegates, speakers, stand personnel, guests and staff should wear their badges, for security reasons, at all times during the meeting. Access to the meeting rooms and exhibition area will be denied to people not wearing badges.

Car parking

There is a 24-hour pay and display car park directly below the Harrogate Convention Centre, please note that the entry and exit shutters are open from 06:00 to 23:59.
For further information on parking, please visit: <https://www.harrogateconventioncentre.co.uk/visitors/parking>.

Cloakroom

A Cloakroom will be available is available in the entrance foyer, please note that this is unmanned.

CME Points

The following CME points will be available for this meeting:

Thursday 14 September: 6 Points
Friday 15 September: 5 Points

Certificates will be emailed to delegates after the meeting.

Directions

Harrogate Convention Centre is just a seven-minute walk (or short taxi ride) from Harrogate train station. Taxi services are available across the road opposite the main doors of the station. Please enter Harrogate Convention Centre via Entrance 3.

Exhibition - Hall D

BSUR & BAUS Endourology are delighted to have received so much support from our trade partners and we hope you will take the opportunity to visit their stands.
The exhibition and catering area will be in the Hall D.

Mobile Phones

As a courtesy to speakers and other delegates, please could you ensure that all mobile phones and devices are either turned off or switched to silent mode whilst in the sessions.

Posters

Posters will be available to view in the exhibition in Hall D.

General Information continued

Refreshments & Lunch

Refreshments and lunch will be available alongside the exhibition in Hall D and are included in the registration fee. NB: We endeavour to accommodate all dietary requirements where possible with each venue. However, not all dietary requirements or preferences can be accommodated. If you would like further information, please email events@baus.org.uk

Registration Desk

Please enter via entrance 3 and you will be directed upstairs to registration. The registration desk will be open at the following times:

Thursday 14 September: 0830 - 1800
Friday 15 September: 0830 - 1330

Social Dinner

The Conference Dinner will take place at the Majestic Hotel Ballroom on Thursday 14 September. Please see the registration desk for ticket availability.

Sessions

Thursday 14 September

Joint BSUR & BAUS Endo Sessions will be in the Queens Suite
BSUR Gynae Sessions will be in the Crown Suite.

Friday 15 September

BAUS Sessions will be in Queens Suite 1
BSUR Sessions will be in Queens Suite 2

Taxis

Blue Line Taxis Tel: **01423 530 830** or
Mainline Taxis Tel: **01423 555555**
The nearest taxi rank is on Montpelier Road.

Wi-Fi

Free Wi-Fi will be available throughout the venue. Look for 'Venue Wifi' on your connections list. No need for sign-up or passwords, just connect and accept the T&Cs.



You're in control.

Realise the possibilities with innovation that covers your procedures.

Flexor® Parallel™ Rapid Release™ Ureteral Access Sheath



NGage® Nitinol Stone Extractor



Black Silicone Filiform Double Pigtail Ureteral Stent Set



Fiber Dust®
Thulium Fiber Laser



Cyber Ho 150
Ultra High Power Holmium Laser System



Thursday 14 September

Queens Suite

Crown Suite

BAUS Endo & BSUR Joint Sessions

9:30-9:45

Welcome

Sri Sriprasad (Chair Endo BAUS) Dartford and Gravesham NHS Trust

Faye Cuthbert (Chair BSUR) University Sussex Hospitals NHS Trust

Atif Khan Leeds Teaching Hospitals NHS Trust,

Harry Bardgett Bradford Teaching Hospitals NHS Trust

Hari Ratan Nottingham University Hospitals NHS Trust
(meeting organisers)

9:45-10:45

Duty of Candour

*Chairs: **Subu Subramonian**, University Hospitals Birmingham NHSFT and **Ros Ahmad**, University Hospitals of Leicester*

What is Duty of Candour?

David Earl, Harrogate and District NHS Trust

What the RCR says we should do

Chris Hammond, Leeds Teaching Hospitals NHS Trust

What BAUS/RCSE says we should do

Steve Miller, Nottingham University Hospitals NHS Trust

Case studies

Subu Subramonian, University Hospitals Birmingham NHSFT and **Ros Ahmad** University Hospitals of Leicester to submit cases to:

Chris Hammond, **Steve Miller** and **David Earl**, Harrogate and District NHS Trust

10:45-11:15

Coffee Break and Exhibition Viewing

Thursday 14 September

Queens Suite

Crown Suite

BAUS Endo & BSUR Joint Sessions

11:15-12:45

Emergencies and Complications

*Chairs: **Bhaskar Somani**, University Hospital Southampton and
Maryna Lewinski, Stockport NHS Trust*

Pregnancy

Radiation Protection in Pregnancy

Jeannette Kraft, Leeds Teaching Hospitals NHS Trust

Imaging of acute abdomen in pregnancy

Rebecca Wiles, Liverpool University Hospitals NHS Foundation Trust

Stone management in pregnancy

Sri Sriprasad, Dartford and Gravesham NHS Trust

Iatrogenic Ureteric Trauma

Imaging of suspected ureteric injury

Amit Patel, Lister Hospital, Stevenage

Endoscopic management of ureteric injury

Joe Philip, North Bristol NHS Trust

Intractable Lower Tract bleeding

Urological management

Kim Davenport, Cheltenham General Hospital

Can the skills of PAE be adapted?

Tim Bryant, University Hospital Southampton NHS Foundation Trust

Thursday 14 September

Queens Suite

Crown Suite

12:45-13:45

1245-1250 Commercial Break - Olympus

Lunch and Exhibition Viewing

BAUS Endo & BSUR Joint Session

13:45-14:15

The Malcolm Coptcoat Lecture

Clare Allen, University College Hospital, London

14:15-15:15

Endo BAUS & UroBSUR Joint Session

The Perfect Team

Chairs: **Harry Bardgett**, Bradford Teaching Hospitals NHS Trust and **Matt Bultitude**, Guy's and St Thomas' NHS Trust

4 complex cases requiring the combined skills of Endo-urology and Uro-IR

Team UCL: **Daron Smith** and **Clare Allen**

Team Nottingham: **Hari Ratan** and **Jon Lloyd**

Team St George's: **Rashmi Singh** and **Uday Patel**

Team Newcastle: **Alistair Rogers** and **Phil Haslam**

Gynae BSUR

Endometriosis: a complex but common problem

Chairs: **Faye Cuthbert**, University Sussex Hospitals NHS Trust and **Rebecca Wiles**, Liverpool University Hospitals NHS Foundation Trust

The surgical perspective: what I need to know from radiology

Christian Kremer, NHS Endometriosis Centre, Mid Yorkshire NHS Trust

Endometriosis: expected findings and how best to image them

Leanne Greenwood, NHS Endometriosis Centre, Mid Yorkshire NHS Trust

Endometriosis: unexpected findings and why to think of endometriosis

Shital Nagtode, NHS Endometriosis Centre, Mid Yorkshire NHS Trust

15:15-15:45

Coffee Break and Exhibition Viewing

Thursday 14 September

Queens Suite

Crown Suite

15:45-17:15

Endo BAUS & UroBSUR Joint Session

Current and future provision of NVIR

*Chairs: **Balraj Dhesi**, University Hospitals Birmingham NHSFT and **Dhaval Bodiwala**, Nottingham University Hospitals*

BAUS Nephrostomy audit

Subu Subramonian, University Hospitals Birmingham NHSFT

ASGBI Emergency General Surgery Audit

Adam Peckham-Cooper, Leeds Teaching Hospitals NHS Trust

Addressing the provision of NVIR in non-arterial centres

Phil Haslam, Newcastle upon Tyne Hospitals NHS Foundation Trust & **Chris Clarke**, Nottingham University Hospitals NHS Trust

Gynae BSUR

Hot topics in Gynae Oncology

*Chairs: **Sarah Swift**, Leeds Teaching Hospitals NHS Trust and **Nishat Bharwani**, Imperial College Healthcare NHS Trust*

Imaging of Borderline Ovarian Tumours

Beth Hankinson, Consultant Radiologist, Liverpool University Hospitals NHS Foundation Trust

Clinical management of Borderline Ovarian Tumours

Siân Taylor, Consultant Surgeon, Liverpool Women's Hospital

Molecular Advances in Gynae Pathology and Impact on Patient Management

Rachel Cooper, Consultant Clinical Oncologist, Leeds Cancer Centre

Imaging Uterine Sarcomas

Lois MacDonald, Manchester University NHS Foundation Trust

Thursday 14 September

Queens Suite

Crown Suite

BAUS Endo & BSUR Joint Session

17:15-18:00

Quiz

Harry Bardgett Bradford Teaching Hospitals NHS Trust and
Hari Ratan Nottingham University Hospitals NHS Trust

North

Susan Hall, Nottingham City Hospital

Jake Patterson, Sheffield Teaching Hospitals NHSFT

Phil Haslam, Newcastle upon Tyne Hospitals NHS
Foundation Trust

Ros Ahmad, University Hospitals of Leicester

South

John Bycroft, Lister Hospital

Max Johnston, Salisbury District Hospital

Jonathan Richenberg, University Sussex Hospitals NHS
Trust

Clare Allen, University College Hospital, London

18:00-18:30

Drinks Reception in the Exhibition Hall

19:30-23:00

Conference Dinner - Majestic Hotel Ballroom

Friday 15 September

Queens Suite 1

Queens Suite 2

09:00-10:05

Endo BAUS

Poster Session 1

Chairs: **John Cobley**, Royal United Hospital, Bath and
John Bycroft, Lister Hospital

See page 28 for presentations

BSUR

Adrenals – hidden pandemic or bane of our lives?

Chairs: **Atif Khan**, Leeds Teaching Hospitals NHS Trust and
Tristan Barrett, Cambridge University Hospitals

Does secondary prevention management of adrenal incidentalomas fulfil any of the rules of screening?

Harry Bardgett, Bradford Teaching Hospitals NHS Trust

Adrenal Incidentalomas: The Endocrinologist's perspective

Afroze Abbas Leeds Teaching Hospitals NHS Trust

Review of International Guidelines, imaging of incidentalomas and Leeds practice

Andy Scarsbrook Leeds Teaching Hospitals NHS Trust & University of Leeds

Surgical view of the adrenal and Adrenal MDT

Sheila Fraser St James's University Hospital, Leeds

Case Discussion

15 mins

10:05-10:15

Late Breaking News

New holmium and thulium laser eye safety proposals

Jake Patterson, Sheffield Teaching Hospitals NHSFT

Friday 15 September

Queens Suite 1

Queens Suite 2

10:15-10:45

1015-1020 Commercial Break - Cook Medical

1015-1020 Commercial Break - Lucida Medical

Coffee Break and Exhibition Viewing

1040-1045 Commercial Break - Macromed UK Ltd

10:45-11:45

Endourology Nurses Session

*Chairs: **Sean Marshall-Kellie**, Clinical Nurse Specialist in Stone Disease, Freeman Hospital, The Newcastle upon Tyne Hospitals NHS Foundation Trust, **Amanda Fuller**, Stone Nurse Specialist, Bristol and **Alistair Rogers**, Freeman Hospital, The Newcastle upon Tyne Hospitals NHS Foundation Trust*

Your Stone Team needs you - Developing a business case

Jane Collie, Specialist Endourology Nurse, Royal Devon University Healthcare NHS Foundation Trust

Developing a Nurse-Led Lithotripsy service

Catherine Owen, Clinical Nurse Specialist in Stone Disease, Leeds Teaching Hospitals

Nurse-Led Metabolic Screening: a meticulous affair

Siobhán Price, Clinical Nurse Practitioner Endourology University College London Hospitals

11:45-12:15

Chairman's Address:

Sri Sriprasad (Chair Endo BAUS), Dartford and Gravesham NHS Trust

Silver Utereroscope Award

Wasim Mahmalji, Hereford

Potpourri

*Chairs: **Samantha Patek** and **Julian Keanie**, Western General Hospital, Edinburgh*

Common and uncommon lesions of the lower GU tract

Dan Petty, York and Scarborough Teaching Hospitals NHS Foundation Trust

What to see on mpMR prostate that is nothing to do with prostate cancer

Sam Withey, Royal Marsden Hospital

When is a testicular mass not cancer

Jonathan Richenberg, University Sussex Hospitals NHS Trust

SpR Oral Presentations

See page 19 for presentations

Friday 15 September

Queens Suite 1

Queens Suite 2

12:15-12:30

Joint Farewell

12:30-13:30

1230-1235 Commercial Break - Karl Storz Endoscopy UK Ltd

Lunch and Exhibition Viewing

1325-1330 Commercial Break - Richard Wolf UK Ltd

13:30-14:15

Poster Session 2

Chairs: **Sarah Howles**, Churchill Hospital, Oxford and
Louise Paramore

See page 29 for presentations

BSUR AGM

14:15-15:15

Office Endourology

Chairs: **Dominic Hodgson**, Queen Alexandra Hospital,
Portsmouth and **James Brewin**, Salisbury NHS Foundation Trust

Outpatient BPH MIS

Feras Al Jaafari, NHS Fife

Outpatient stent changes

Amelia Pietropaolo, University Hospital Southampton

Outpatient Diode laser TULA

Andy Moon, Freeman Hospital, Newcastle

Case of the Day

Chairs: **Harry Bardgett**, Bradford Teaching Hospitals NHS Trust,
Atif Khan, Leeds Teaching Hospitals NHS Trust and
Faye Cuthbert (Chair BSUR) University Sussex Hospitals
NHS Trust

Created by **Andrew Koo**, Harrogate District Hospital
Rachel Hubbard, Sheffield Teaching Hospitals
Shiva Deep Sukumar, Calderdale Hospitals NHS Trust
Haniya Kazi, Bradford Teaching Hospitals NHS Trust
Pre-recorded case

Nicola Lee, Bradford Teaching Hospitals NHS Trust
Aarushi Gangahar, Mid Yorkshire Hospitals NHS Trust

15:15-15:30

BAUS Farewell

BSUR Farewell

Exhibition Plan & Sponsors

BSUR & BAUS Endourology Joint Meeting 2023 is a sponsored event. All companies that will be sponsoring the event are named and have no input into the content of the programme and selection of speakers.

We are very grateful to the support from the following sponsors:

- 1 Karl Storz Endoscopy (UK) Ltd (Premium Sponsor)
- 2 Richard Wolf UK Ltd (Premium Sponsor)
- 3 Macromed UK Ltd (Premium Sponsor)
- 4 Cook Medical (Premium Sponsor)
- 5 Olympus (Platinum Sponsor)
- 6 Lucida Medical Ltd (Premium Sponsor)
- 7 Healthcare Supply Solutions
- 8 Fannin UK Ltd
- 9 Guerbet Laboratories
- 10 Hollister Ltd
- 11 HSL
- 12 Varian
- 13 Argon Medical Devices
- 14 Hexarad
- 16 Boston Scientific
- 17 Kebomed UK
- 18 Creo Medical UK Ltd
- 19 Coloplast
- 20 Novus Med
- 21 Bayer Plc
- 22 Canon Medical Systems
- 23 Biospectrum Ltd
- 24 Rocamed
- 25 LaproSurge Ltd
- 26 CJ Medical
- 27 Mobile Health Systems
- 28 The Urology Foundation

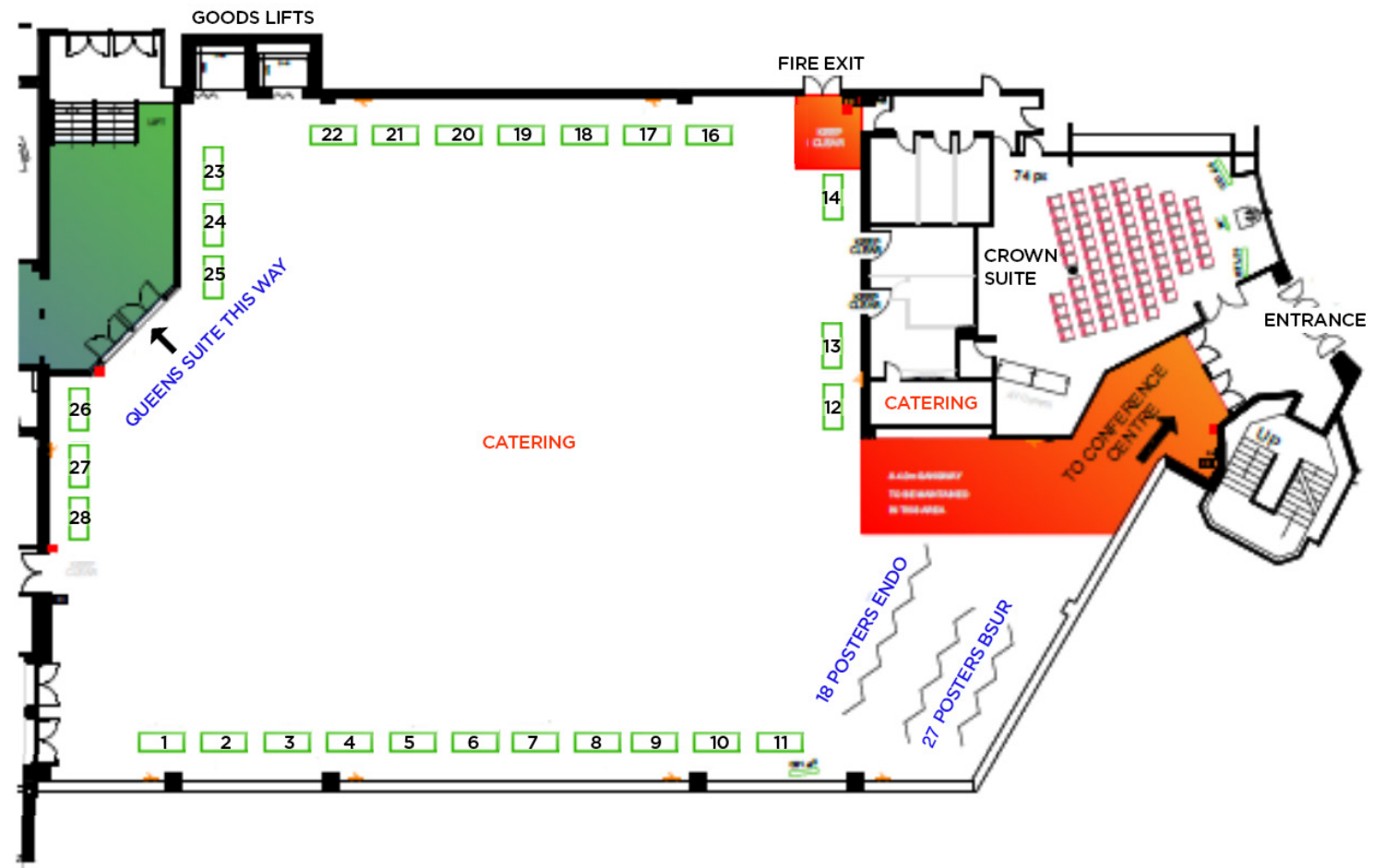

HALL D



Customize Your Scope Mix

- ✓ Meet your **clinical needs**
- ✓ Achieve your **cost-per-procedure** targets

KARL STORZ offers digital, fibre, and single-use uretero-renoscopes that can be used with a variety of imaging systems.

BSUR Oral Presentations

The BSUR Oral presentations are as follow:

AI for prostate MRI: results from a large multi-centre, multi-vendor external validation study

Authors:

Antony Rix - Lucida Medical Ltd
Aarti Shah - Hampshire Hospitals NHS Foundation Trust
Nadia Moreira da Silva - Lucida Medical Ltd
Michael Yeung - Lucida Medical Ltd
Francesco Giganti - University College London
Lucy Davies - Lucida Medical Ltd
Paul Burn - Somerset NHS Foundation Trust
Richard Hindley - Hampshire Hospitals NHS Foundation Trust
Nikhil Vasdev - East and North Herts NHS Trust
John Hayes - East and North Herts NHS Trust
Sophie Squire - Hampshire Hospitals NHS Foundation Trust
Alison Bradley - Royal Cornwall Hospitals NHS Trust
Giles Maskell - Royal Cornwall Hospitals NHS Trust
Adrian Andreou - Royal United Hospitals Bath NHS Foundation Trust
Sidath Liyanage - Mid and South Essex NHS Foundation Trust
Mark De Bono - Mid and South Essex NHS Foundation Trust
Raj Persad - North Bristol NHS Trust, Jon Aning - North Bristol NHS Trust
Nimalan Sanmugalingam - Cambridge University Hospitals NHS Foundation Trust
Tristan Barrett - Cambridge University Hospitals NHS Foundation Trust
Mark Hinton - Lucida Medical Ltd
Evis Sala - Policlinico Universitario A. Gemelli - IRCCS, Dept. of Radiology

Category: Urological

GI recurrence of endometrial cancer - an important mimic

Authors:

Ujani Jahnavi Reid - Leeds Teaching Hospitals

Category: Gynaecological

Availability of operative and implant information as part of referrals to the London Complex Mesh Centre

Authors:

Jina Pakpoor - University College London Hospital
Naomi Sakai - University College London Hospital
Bethany Jackson - University College London Hospital
Navin Ramachandran - University College London Hospital
Paul Aughwane - University College London Hospital

Category: Gynaecological

Ovarian Vein Embolisation for Pelvic Congestion Syndrome

Authors:

Asma Bitar De Zayas-Enriquez - St George's Hospital
Leto Mailli - St George's Hospital
Lakshmi Ratnam - St George's Hospital

Category: Interventional Radiology

Does including histological outcomes in an mpMRI report for query prostate cancer change the proportion of patients who elect to proceed to biopsy?

Authors:

William Stevens - Leeds Teaching Hospitals NHS Trust
Catherine Parchment-Smith - Mid Yorkshire Hospitals NHS Trust
Ese Adiotomre - Leeds Teaching Hospitals NHS Trust
Oliver Hulson - Leeds Teaching Hospitals NHS Trust
Atif Khan - Leeds Teaching Hospitals NHS Trust
Philip Melling - Leeds Teaching Hospitals NHS Trust
Sacha Pierre - Leeds Teaching Hospitals NHS Trust
Jonathan Smith - Leeds Teaching Hospitals NHS Trust

Category: Urological



macromed

Combining the depth of scope of a multinational with the customer focus of an Independent UK company

BSUR Posters

The BSUR Posters are as follow:

1 Pictorial review of unexpected fluoroscopy cystogram findings

Authors:

Amy Dixon - Leeds Teaching Hospitals
Kathryn Murrell - Leeds Teaching Hospitals
Michelle - Scaife
Atif Khan - Leeds Teaching Hospitals

Category: Urological

2 Malakoplakia mimicking a locally advanced renal malignancy - a case review

Authors:

Rajashri Patil - James Cook University Hospital South Tees NHS Foundation Trust Middlesbrough
Samuel Lund - James Cook University Hospital South Tees NHS Foundation Trust Middlesbrough
Abdelazim Mohammed - James Cook University Hospital South Tees NHS Foundation Trust Middlesbrough

Category: Urological

3 Iatrogenic renal infarction complicated by reno-colic fistula- a novel case study

Authors:

Rajashri Patil - James Cook University Hospital South Tees NHS Foundation Trust Middlesbrough
Samuel Lund - James Cook University Hospital South Tees NHS Foundation Trust Middlesbrough
Abdelazim Mohammed - James Cook University Hospital South Tees NHS Foundation Trust Middlesbrough

Category: Urological

4 Renal Cell Carcinoma Stage T3a: Comparing Radiological and Histological Staging

Authors:

Ayesha Khan - East Lancashire Hospital Trust
Dr Usman Saeed - East Lancashire Hospital Trust
Dr Allen Ikwuagwu - East Lancashire Hospital Trust

Category: Urological

5 Is thoracic CT required when staging T1 cervical cancer? Re-audit.

Authors:

Haroon Khan - Royal Stoke University Hospital

Category: Gynaecological

6 Multimodality imaging for the assessment of Vulvar cancer – a pictorial review

Authors:

Emma Watura - University Hospitals Sussex NHS Foundation Trust
Henry Simon - University Hospitals Sussex NHS Foundation Trust
Samantha Fossey - University Hospitals Sussex NHS Foundation Trust
Faye Cuthbert - University Hospitals Sussex NHS Foundation Trust

Category: Gynaecological

BSUR Posters continued

7 How good are we at assessing myometrial and cervical stromal invasion? An audit of Accuracy of MRI staging of endometrial cancers

Authors:

Susan Geary - *Sherwood Forest Hospitals NHS Trust*
Dr Husain Tahir - *Sherwood Forest Hospitals NHS Trust*
Dr Zena Ahmad - *Nottingham University Hospitals*
Dr Samiya Ibrahim - *Nottingham University Hospitals*
Mohammed Saeed - *Sherwood Forest Hospitals NHS Trust*
Althaf Rasheed - *Nottingham University Hospitals NHS Trust*

Category: Gynaecological

8 Performance of the O-RADS MRI Scoring System for Risk Stratification of Indeterminate Adnexal Masses in a Tertiary Gynaecology Oncology Centre

Authors:

Dr Charlotte Thompson - *University Hospitals Bristol and Weston NHS Foundation Trust*
Dr Isabel Haines - *University Hospitals Bristol and Weston NHS Foundation Trust*
Dr Naomi Fenton - *University Hospitals Bristol and Weston NHS Foundation Trust*

Category: Gynaecological

9 Accuracy of MRI in Diagnosis of FIGO Stage 1 Endometrial Carcinoma

Authors:

Bhavana Shyamanur - *Hull University Teaching Hospitals NHS Trust*
Corinna Hauff - *Hull University Teaching Hospitals NHS Trust*
Stephanie Walden - *Hull University Teaching Hospitals NHS Trust*

Category: Gynaecological

10 The benefits of a Compartment-Based MR Imaging Approach for Endometriosis and Its Implications in subsequent management: A Pictorial Review

Authors:

Zaha Hamam - *Imperial College Healthcare NHS Trust*
Geetanjali Kakar - *Imperial College Healthcare NHS Trust*
Nishat Bharwani - *Imperial College Healthcare NHS Trust*

Category: Gynaecological

11 The evaluation of the accuracy of Preoperative risk stratification in patients with localised prostate cancer

Authors:

Aashay Vaidya - *Stockport NHS Foundation Trust*
Ijeoma Chibuzo - *Stockport NHS Foundation Trust*
Yuhao Zhang - *Stockport NHS Foundation Trust*
Paul Cleaveland - *Stockport NHS Foundation Trust*
Richard Brough - *Stockport NHS Foundation Trust*
Gerald Collins - *Stockport NHS Foundation Trust*
Andrew Sinclair - *Stockport NHS Foundation Trust*
Umi Hatimy - *Stockport NHS Foundation Trust*
Emily Burns - *Stockport NHS Foundation Trust*
Vicent Tang - *Stockport NHS Foundation Trust*

Category: Urological

BSUR Posters continued

12 Integrating clinical data with AI to optimise biopsy decisions after prostate MRI

Authors:

Antony Rix - Lucida Medical Ltd
Nadia Moreira da Silva - Lucida Medical Ltd
Jobie Budd - Lucida Medical Ltd
Michael Yeung - Lucida Medical Ltd
Francesco Giganti - University College London
Lucy Davies - Lucida Medical Ltd
Paul Burn - Somerset NHS Foundation Trust
Richard Hindley - Hampshire Hospitals NHS Foundation Trust
Nikhil Vasdev - East and North Herts NHS Trust Stevenage
Alison Bradley - Royal Cornwall Hospitals NHS Trust
Giles Maskell - Royal Cornwall Hospitals NHS Trust
Adrian Andreou - Royal United Hospitals Bath NHS Foundation Trust
Sidath Liyanage - Mid and South Essex NHS Foundation Trust
Raj Persad - North Bristol NHS Trust
Jon Aning - North Bristol NHS Trust
Tristan Barrett - Cambridge University Hospitals NHS Foundation Trust
Mark Hinton - Lucida Medical Ltd
Anwar Padhani - Paul Strickland Scanner Centre
Evis Sala - Policlinico Universitario A. Gemelli, IRCCS Dept. of Radiology Rome
Aarti Shah - Hampshire Hospitals NHS Foundation Trust

Category: Urological

13 The Role of Prophylactic Antibiotics in Transperineal Prostate Biopsy

Authors:

Mihir Rao - Leeds Teaching Hospitals Trust
Jim Zhong - Leeds Teaching Hospitals Trust
Steven Yong Keen Hor - Leeds Teaching Hospitals Trust
Krishanth Ganesan - NHS Education for Scotland (NES)
Heidi Salminen - NHSE Education Yorkshire and The Humber

Reshma Mary Koshy - Leeds Teaching Hospitals Trust
Atif Khan - Leeds Teaching Hospitals Trust
Oliver Hulson - Leeds Teaching Hospitals Trust

Category: Urological

14 Efficacy of transperineal prostate biopsy under local anaesthesia (LATP): How does it compare for our patients?

Authors:

Paul Lim - Alexandra Hospital Redditch
Joanna Low - Alexandra Hospital Redditch
Emma Hurton - Alexandra Hospital Redditch
William Gallagher - Alexandra Hospital Redditch
Paul Rajjayabun - Alexandra Hospital Redditch

Category: Urological

15 CT KUBs for stones and unearthing unexpected gems

Authors:

Adrian Ho - University Hospital Southampton
Dr Tom Chance - University Hospital Southampton
Dr Dafydd Ifan - University Hospital Southampton

Category: Urological

BSUR Posters continued

16 Contrast enhanced ultrasound for indeterminate testicular lesions – a pictorial review

Authors:

Aurimas Kudzinskas - *University Hospitals Sussex NHS Foundation Trust*
Emma Watura - *University Hospitals Sussex NHS Foundation Trust*
Emma Simpson - *University Hospitals Sussex NHS Foundation Trust*
Faye Cuthbert - *University Hospitals Sussex NHS Foundation Trust*

Category: Urological

17 TB or not TB? - Radiological and clinical features of a renal tuberculosis case mimicking renal urolithiasis

Authors:

Anastasia Baltasheva - *Salford Royal Hospital*
Timothy Napier-Hemy - *Salford Royal*
David Ross - *Salford Royal*
Syahminan Suut - *Salford Royal*

Category: Urological

18 A novel Risk calculator incorporating PSMA PET and mpMRI in the primary diagnosis of clinically significant prostate cancer.

Authors:

Gideon Ptasznik - *Monash University*

Category: Urological

19 Clinical Impact of Cystography in Post-Prostatectomy Patients with Vesicourethral Anastomotic Leak

Authors:

Dr Bukola Ogunjinmi - *University Hospitals Dorset NHS Foundation Trust*
Dr Harout Kolanjian - *University Hospitals Dorset NHS Foundation Trust*
Dr James Franklin - *University Hospitals Dorset NHS Foundation Trust*
Dr William Blevins - *University Hospitals Dorset NHS Foundation Trust*
Dr Ben Edwards - *University Hospitals Dorset NHS Foundation Trust*

Category: Urological

20 A systematic review interrogating the variation in how PSMA PET is performed and reported in the primary diagnosis of Prostate cancer.

Authors:

Gideon Ptasznik - *Monash University*

Category: Urological

21 Can novel imaging technologies obviate the need for prostate biopsy?

Authors:

Gideon Ptasznik - *Monash University*

Category: Urological

BSUR Posters continued

22 The Elusive Anal Verge: Intestinal involvement of pelvic endometriosis on MRI.

Authors:

Clodagh Mangan - *Queen Elizabeth University Hospital*
Joanna McNeil - *Queen Elizabeth University Hospital*

Category: Gynaecological

23 Diagnostic accuracy of MRI for deep infiltrative endometriosis of the ureters, bowel and pelvic side walls

Authors:

Yixi Bi - *University Hospital North Midlands*
Vaanathi Paulvannan - *University Hospital North Midlands*
Ka-Wing Chu - *University Hospital North Midlands*
Arjun Vora - *University Hospital North Midlands*
Ola Stankiewicz - *University Hospital North Midlands*

Category: Gynaecological

24 Don't get your head in a twist: A pictorial review of the multimodality appearances of adnexal torsion

Authors:

Olivia Goldberg - *Imperial College Healthcare NHS Trust*
Nishat Bharwani - *Imperial College Healthcare NHS Trust*

Category: Gynaecological

25 Assessing extent of practice of metallic ureteric stent at LTHT

Authors:

Haroon Hussain - *LTHT*
Ming-Te Lee - *LTHT*
Atif Khan - *LTHT*
Haroon Motara - *LTHT*

Category: Interventional Radiology

26 The first 5 targeted trans-perineal prostate biopsies diagnose the majority of PROMIS criteria cancer in patients with a Likert 4 or 5 score on mpMRI

Authors:

William Stevens - *Leeds Teaching Hospitals NHS Trust*
Catherine Parchment-Smith - *Mid Yorkshire Hospitals NHS Trust*
Ese Adiotomre - *Leeds Teaching Hospitals NHS Trust*
Oliver Hulson - *Leeds Teaching Hospitals NHS Trust*
Atif Khan - *Leeds Teaching Hospitals NHS Trust*
Roger Adrian - *Leeds Teaching Hospitals NHS Trust*
Philip Melling - *Leeds Teaching Hospitals NHS Trust*
Adam Morrell - *Leeds Teaching Hospitals NHS Trust*
Sacha Pierre - *Leeds Teaching Hospitals NHS Trust*
Jonathan Smith - *Leeds Teaching Hospitals NHS Trust*

Category: Interventional Radiology

BSUR Posters continued

27 Review of renal lesion biopsy service in a large teaching hospital over 5 years

Authors:

Ming-Te Lee - *Leeds Teaching Hospital Trust*

Ken Vin Wong - *Leeds Teaching Hospital Trust*

Taryn Cruickshank - *Leeds Teaching Hospital Trust*

Omar Abdel-Hadi - *Leeds Teaching Hospital Trust*

Simon Burbidge - *Leeds Teaching Hospital Trust*

Jonathan Smith - *Leeds Teaching Hospital Trust*

Tze Min Wah - *Leeds Teaching Hospital Trust*

Category: Interventional Radiology



RIWO 
D-URS

BAUS Endourology Poster Presentations

Poster Session 1 will take place 0900-1005 on Friday 15 September
Each presentation will be 3 minutes long with 2 minutes for Q&A. The presentation order will be as follows:

1-1 Mendelian randomisation and colocalization analyses reveal novel drug targets for the prevention of kidney stone disease

Lovegrove C¹, Hannan F¹, Mahajan A¹, Thakker R¹, Holmes M², Furniss D^{1,3}, Howles S^{1,3}

¹University of Oxford, Oxford, United Kingdom, ²University of Bristol, Bristol, United Kingdom, ³Oxford University Hospitals NHS Foundation Trust, Oxford, United Kingdom

1-2 Is Traditional Stone Clinic an Ideal use of NHS Resources?

Corkill J¹, Sale A, Jefferies E

¹Royal United Hospital Bath, Bath, United Kingdom

1-3 Improving the Emergency Urology Stone Pathway with Elective Theatre Utilisation: A Closed Loop Audit

Zhu L², Nathan A^{1,2}, Rosa N¹, Ng A^{1,2}, Riley M¹, Khalifeh M¹, Goyal A¹, Singh P¹, Ellis G¹, Allen D¹, Kucheria R¹, Ajayi L¹

¹Royal Free Hospital, London, United Kingdom, ²Division of Surgery and Interventional Science, University College London, London, United Kingdom

1-4 An audit of the morbidity of waiting for a PCNL

Tezcan E¹, Rosli M¹, Hall S¹, Miller S¹, Scriven S¹, Ratan H¹, Bodiwala D¹

¹Nottingham University Hospitals NHS Trust, Nottingham, United Kingdom

1-5 The lasting effect of the COVID-19 pandemic: Outcomes for patients awaiting percutaneous nephrolithotomy (PCNL)

Crossland A¹, Forster J, Stewart A, Basu S

¹Bradford Teaching Hospitals NHS Foundation Trust, Bradford United Kingdom

1-6 Can we rely on the published evidence comparing the environmental impact of single use and reusable flexible cystoscopes? A systematic review of published environmental impact assessments.

John J¹

¹Royal Devon University Healthcare NHS Foundation Trust, Exeter, United Kingdom,

²University of Exeter, Exeter, United Kingdom

1-7 Environmental impact of flexible cystoscopy: A comparative analysis between the carbon footprint of Isiris® single-use cystoscope and reusable flexible cystoscope and a systematic review of literature

Jahrreiss V^{1,2}, Sarrot P³, Davis N⁴, Somani B¹

¹University Hospital Southampton, NHS Trust, Southampton, United Kingdom,

²Department of Urology, Medical University of Vienna Vienna Austria ³Medical

affairs department, Coloplast, Le Plessis-Robinson, France, ⁴Department of Urology, Beaumont Hospital and Royal College of Surgeons in Ireland, Ireland

1-8 Outcomes of Ultrasound guided ESWL

Patel A¹, Turney B¹, Howles S¹, Jour I¹, Keskin S¹, Mabrouki M¹, Yassin M¹, Spencer M¹, Grout E¹

¹Churchill Hospital, Oxford, United Kingdom

BAUS Endourology Poster Presentations continued

Poster Session 2 will take place 1330-1415 on Friday 15 September,
Each presentation will be 3 minutes long with 2 minutes for Q&A. The presentation order will be as follows:

1-9 The CALCULator. Using Local Data and Supervised Machine Learning to Create a Useable Prediction Tool for Emergency Shockwave Lithotripsy.

Wilson J¹, Crompton S², Manley J², Dunn J², Prynne J², Irish A², Sanderson G², Dickinson A²

¹Cheltenham General Hospital, Cheltenham, United Kingdom, ²Plymouth Hospitals NHS Trust, Plymouth, United Kingdom

1-10 Stent Guardians & Safety Administrators: A Necessity to prevent Lost Stents?

Minto T¹, Fuller A, March P, Quick C, Parry J, Harris A, Collin N, Collin G, Timoney A, Lee S, AlBuheissi S, Philip J

¹Bristol Urological Institute, Bristol, United Kingdom

2-1 Thulium Fiber Laser and 14-Fr Super-Mini Percutaneous Nephrolithotomy

Sarna S, Edison E, Adlam J, Allen C, Arumham V, Choong S

¹University College Hospital London, London, United Kingdom

2-2 Nephrostomy insertion in malignant ureteric obstruction does not significantly improve renal function at 3 months

Chandran A^{1,2}, Mehta S^{1,2}, Bajracharya V^{1,2}, Gleitzman O^{1,2}, Willis S¹

¹Guy's Hospital and St Thomas' (GSTT), London, United Kingdom, ²Equal First Authorship

2-3 QR codes. A sustainable way to improve patient access to health information.

Crossland A¹, Stewart A

¹Bradford Teaching Hospitals NHS Foundation Trust, Bradford United Kingdom

2-4 JFil®: A New Effective Stent to Improve Tolerability and Reduce Ureteral Stent Symptoms?

Farah M¹, Al-Dhahir W¹, Mohamed A¹, Mahmalji W¹

¹Wye Valley NHS Trust, Hereford, United Kingdom

2-5 Cystolitholapaxy for Large Volume Bladder Stones Using Swiss LithoClast Trilogy: Initial Clinical Experience

Sturgess G¹, Young M¹, Wilcox G¹, Sara X¹, Symons S¹

¹The Mid-Yorkshire Teaching Hospitals, Wakefield, United Kingdom

BAUS Endourology Poster Presentations continued

Poster Session 2 will take place 1330-1415 on Friday 15 September,
Each presentation will be 3 minutes long with 2 minutes for Q&A. The presentation order will be as follows:

2-6 TULA in outpatient settings Tolerability, Safety and Side effects assessed through VAS Score and EORT validated questionnaires

Giona S¹, Ali A¹

¹Frimley Park Hospital, Camberley, United Kingdom

2-7 Traditional and Novel BPH Treatment Options: Would we Treat Ourselves as we Treat our Patients? Results from a Decision-Making Survey among Urologists

Colvin H¹, Johnston M, Ripa F, Mani Sinha M, Pieptropaolo A, Brewin J, Fiori C, Gozen A, Somani B

¹Salisbury District Hospital, Salisbury, United Kingdom, ²Southampton General Hospital, Southampton, United Kingdom

2-8 Causal relationships of metabolic syndrome and benign prostatic hyperplasia

Maxwell K¹, Lovegrove C^{1,2}, Ng M³, Al Jaafari F^{4,5}, Furniss D³, Bryant R^{1,2}, Turney B^{1,2}, Howles S^{1,2}

¹Nuffield Department Of Surgical Sciences, University Of Oxford, Oxford, United Kingdom, ²Department of Urology, Oxford University Hospitals NHS Trust, Oxford, United Kingdom, ³Nuffield Department of Orthopaedics, Rheumatology and Musculoskeletal Sciences, Oxford, United Kingdom, ⁴ Department of Urology, NHS Fife, Fife, United Kingdom, ⁵School of Medicine, University of St Andrews, St Andrews, United Kingdom

BSUR | 20 BAUS Endo | 23

Joint Annual Meeting:
British Society of Urogenital Radiology
British Association of Urological Surgeons, Endourology Section

